

BEX Model P Loader

For AN-FO Blasting Agents

Operation and Maintenance

A. Safety

Any pneumatic loading device may produce static electricity by frictional action of the AN-FO and air moving through the loader and loading hose. To protect personnel from electrical shocks and premature blasts, anti-static hose should be used and the Loader should be electrically grounded (subject to local regulations).

In some areas the local mining regulations forbid the blowing of AN-FO into bore Holes bottom-primed with electrical detonators. In other areas this is permitted after safety checks. Before proceeding contact your local Department of Mines.

B. Operation

The BEX Loader is ready to be used when unpacked.

- 1.) Connect to compressed air supply. Types PA, PB and PC ejector elements are designed for best performance @ 80 P.S.I. but will operate in the 60-120 P.S.I. range with satisfactory results. It is suggested that the Loader be connected to the rock drill air hose with 2 or more Ft. of 1/2" air hose to facilitate the Loader.
- 2.) Connect an approved anti-static loading hose of the appropriate size to the Loader.
- 3.) A grounding lug with wing nut is provided on the Loader and should be used to ground the Loader through a wire connected to a rock bolt or other reliable ground if required by local safety regulations.
- 4.) Having connected the air line, loading hose and static wire open the compressed air valve. Test the remote control valve action by depressing the remote control valve several times. With the standard seven foot control hose the valve should be instantaneous. With longer control hose a slight delay in shutting off is normal.
- 5.) Empty a 50 LBS bag of AN-FO into hopper. To load the hole, insert the anti-static loading hose to full depth of hole and retract about 1 Ft. Depress the control valve lever and the Loader will operate. As the hole fills up, the loading hose must be slowly retracted to avoid blowing the AN-FO out of the hole.

C. Maintenance

After use, the excess blasting agent should be emptied from the Loader and the loader operated for a few seconds to clear the ejector and hose AN-FO. Invert the Loader when not in use so moisture, rock, etc. will not collect in hopper. The ejector assembly should be taken apart occasionally and cleaned with light mineral spirits. Blow clean with air gun.

D. Disassembly

- 1.) Ejector Element: To disassemble the ejector (41P), unscrew the element retaining nut (39P). The element can be removed from the along with O-ring (44P).
- 2.) Body Valve Assembly: Remove the 4 screws and the body valve cover (36P) will then come off along with the rubber body disc (34P) and the body disc insert. Body screen (33P) can be pulled out with needle-nose pliers if necessary. The Body screen holder is not to be removed.

E. Assembly

The valve assembly goes together in reverse order which it was taken apart. When replacing the Ejector Element in the body, check the O-ring seal for nicks or cuts. All parts must be clean before reassembly.

F. Loading Rates and Capacities

3 Types or Ejector Elements are available:

- Type PA. for 5/8" I.D. hose and 1-1/8" holes. Recommended max. hose length of 25FT.
Type PB. for 3/4" I.D. hose and 1-1/4" - 1-3/8" holes. Recommended max. hose length of 30FT.
Type PC. for 1" I.D. hose and 1-1/2" holes. Recommended max. hose length of 40FT.

BEX Model P Loader

TROUBLESHOOTING

The BEX Model "P" Loader has proven to be far superior to any other loader available and has been found to be relatively trouble-free. However, if satisfactory performance is not obtained, the following points should be examined:

- 1.) Damage to O-Ring Seal (44P)
When the Ejector Element (41P) is removed, it should be replaced with reasonable care, Being careful not to damage the O-Ring, as a cut or chip will result in low vacuum or none.
- 2.) The air line oiler should be disconnected when using the Loader.
- 3.) Regardless of the drill-hole size, the proper hose must be used with each Ejector Element.
With a PA Element use 5/8" I.D. Hose.
With a PB Element use 3/4" I.D. Hose.
With a PC Element use 1" I.D. Hose.

Larger hoses than indicated may reduce the density of the loaded AN-FO. Smaller hoses than indicated will reduce the loading rate particularly with the PC Element.

FOR BEST OPERATION THE LOADER MUST MAINTAINED ON A REGULAR SCHEDULE.

BEX Model P-loader-Parts

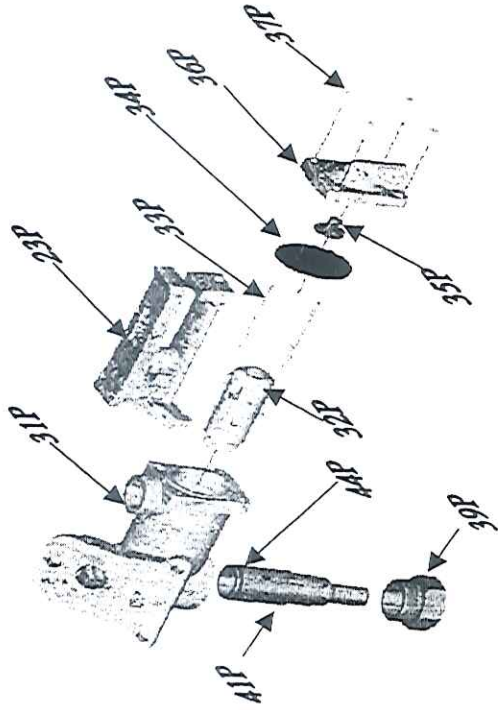
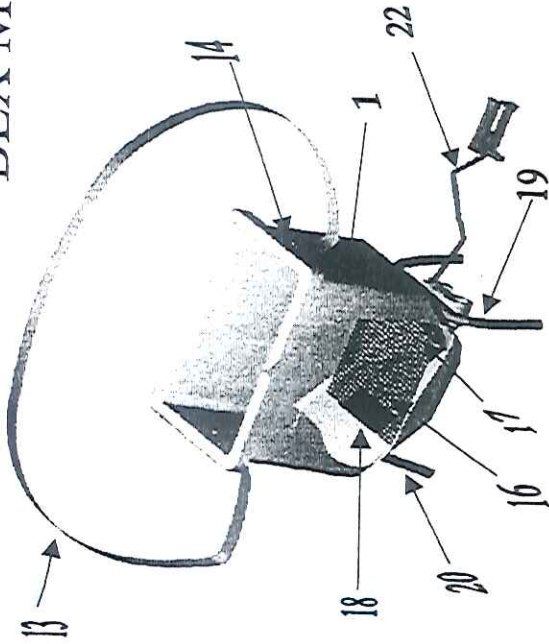

PART NUMBER	Designation	PART NUMBER	Designation
1	Hopper	31P	Ejector Body Type 'p'
13	Adjustable Carrying Strap	32P	Body Screen Holder
14	Strap Bracket w/ Loop	33P	Body Screen Type 'p'
16	AN-FO Screen	34P	Rubber Body Dies
17	Front Inside Plate	35P	Body Disc Insert
18	Rear Inside Plate	36P	Body Vane Cover
19	Front Leg Assembly	37P	Vavle Cover Screws
20	Rear Leg Assembly	39P	Element Retainer Nut
21	Wing Nut	41PB	Ejector Element Type PB
22	Control Hose, Complete	41PA	Ejector Element Type PA
23P	Control Valve, Type P Complete	41PC	Ejector Element Type PC
		44P	O-Ring Seal

